

Series Industrial in PAINTED STEEL

Oxygen - Acetylene

20 bar

swivel
seals
hose

Brass
Viton
SBR/EPDM

S. 540

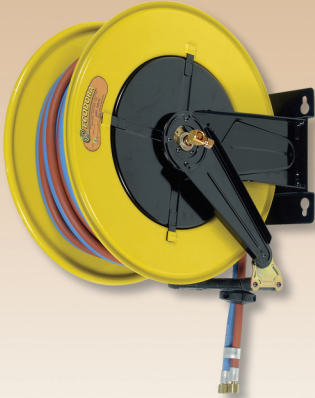

S. 530

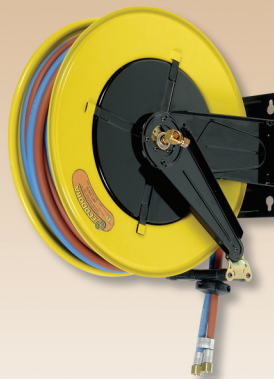

S. 430

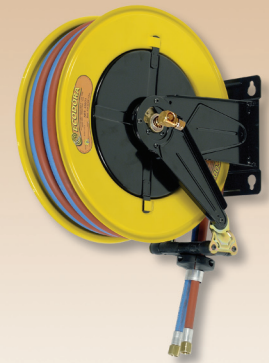

THE HOSE REELS ARE EQUIPPED WITH A UNIVERSAL HOSE STOP; THOSE WITH HOSE ARE PROVIDED WITH A 1,5 m INLET CONNECTION HOSE.

- The template supplied, facilitates drilling of the holes and therefore hose reel fixing.

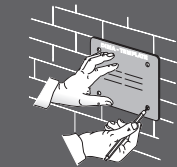

- The quick coupling support (see page 82) that facilitates installation in battery is available on request.

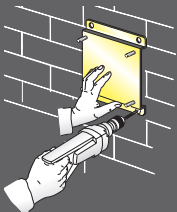

- The quick coupling adjustable support (see page 82) that enables 40° rotation to the right or left of the hose reel is available on request.

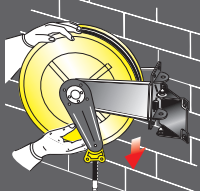

- The adjustable arms can be easily repositioned according to needs (see page 77).

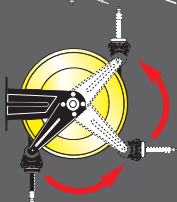

	Article	Relative capacity	Delivery hose	ø Hose	Inlet connection	Outlet connection
Series 430	430/70	800 l/min	without hose	/	M 3/8"G	M 3/8"G
	430/71	250 l/min	13m (993/13)	2x1/4"-2x6	F 3/8"G	F 3/8"G
	430/72	360 l/min	12m (994/12)	2x5/16"-2x8	F 3/8"G	F 3/8"G
		N° 1 packing m³ 0,086		from kg 14 to 24		

Series 530	530/70	800 l/min	without hose	/	M 3/8"G	M 3/8"G
	530/71	220 l/min	17m (993/17)	2x1/4"-2x6	F 3/8"G	F 3/8"G
	530/72	200 l/min	20m (993/20)	2x1/4"-2x6	F 3/8"G	F 3/8"G
	530/73	300 l/min	15m (994/15)	2x5/16"-2x8	F 3/8"G	F 3/8"G
	530/74	290 l/min	20m (994/20)	2x5/16"-2x8	F 3/8"G	F 3/8"G
	530/75	660 l/min	15m (995/15)	2x3/8"-2x9	F 3/8"G	F 3/8"G
		N° 1 packing m³ 0,120		from kg 19 to 42		

Series 540	540/70	800 l/min	without hose	/	M 3/8"G	M 3/8"G
	540/71	180 l/min	25m (993/25)	2x1/4"-2x6	F 3/8"G	F 3/8"G
	540/72	160 l/min	30m (993/30)	2x1/4"-2x6	F 3/8"G	F 3/8"G
	540/73	140 l/min	35m (993/35)	2x1/4"-2x6	F 3/8"G	F 3/8"G
	540/74	270 l/min	25m (994/25)	2x5/16"-2x8	F 3/8"G	F 3/8"G
	540/75	250 l/min	30m (994/30)	2x5/16"-2x8	F 3/8"G	F 3/8"G
	540/76	230 l/min	35m (994/35)	2x5/16"-2x8	F 3/8"G	F 3/8"G
	540/77	640 l/min	20m (995/20)	2x3/8"-2x9	F 3/8"G	F 3/8"G
	540/78	600 l/min	25m (995/25)	2x3/8"-2x9	F 3/8"G	F 3/8"G
	540/79	570 l/min	27m (995/27)	2x3/8"-2x9	F 3/8"G	F 3/8"G
		N° 1 packing m³ 0,175		from kg 24 to 50		

OVERALL DIMENSIONS

Series	A	B	C	D	E	F	G	H
430	186	140	196	226	115	450	420	460
530	203	153	220	258	115	550	510	560
540	300	218	228	268	190	550	510	573

