



Airwork's pneumatic valves combine big resistance, reliability and versatility of assemblage; the VK series can be assembled in several ways: In-line, on panel, on multiple bases, on manifolds and on cylinders. Available size are 1/8, 1/4 and 1/2, the available functions are 3/2, 5/2 e 5/3.

La série des distributeurs pneumatiques à raccordement direct série VK a des caractéristiques multiples de robustesse, de fiabilité et de montage. En ligne, sur embase multiple, assemblée et directement sur le vérin. Elle est disponible en taille 1/8-1/4 et 1/2 ainsi qu'en fonction 3/2, 5/2 et 5/3

La serie di valvole pneumatiche di Airwork, possiedono caratteristiche di grande robustezza, affidabilità e versatilità di montaggio, infatti la serie VK si possono montare in diversi modi: in linea, a parete, su base multipla, su collettori e persino su cilindro. Sono disponibili in tre taglie 1/8, 1/4 e 1/2 nelle funzioni 3/2, 5/2 e 5/3.

TECHNICAL DATA / DONNEES TECHNIQUES / DATI TECNICI

Flow rate 6 bar $\Delta p$ 1 bar / Débit a 6 bar $\Delta p$ 1bar / Portata a 6 bar $\Delta p$ 1bar	1/8=550 Nl/min - 1/4=1100 Nl/min - 1/2=4600Nl/min
Nominal orifice / Diamètre nominal / Diametro nominale	1/8=5mm - 1/4=7.5mm - 1/2=13mm
Response times mono-stable / Temps réponse monostable / Tempi risposta monostabile	(1/8=TRA 6ms / TRR 15ms) (1/4=TRA 7ms / TRR 15ms) (1/2=TRA 24ms / TRR 43ms)
Response times bi-stable / Temps réponse bistable / Tempi risposta bistabile	(1/8=TRA 7ms / TRR 7ms) (1/4=TRA 7ms / TRR 7ms) (1/2=TRA 30ms / TRR 30ms)
Pressure range / Pression d'utilisation / Pressione di esercizio	
* Monostable / Monostable / Monostabile	2.5 ÷ 10 bar
* Bistable / Bistable / Bistabile	1 ÷ 10 bar
Temperature range / Température d'utilisation / Temperatura di esercizio	-10 C° ÷ +60c°

FLOW RATES / COURBE DE DEBIT / PORTATE

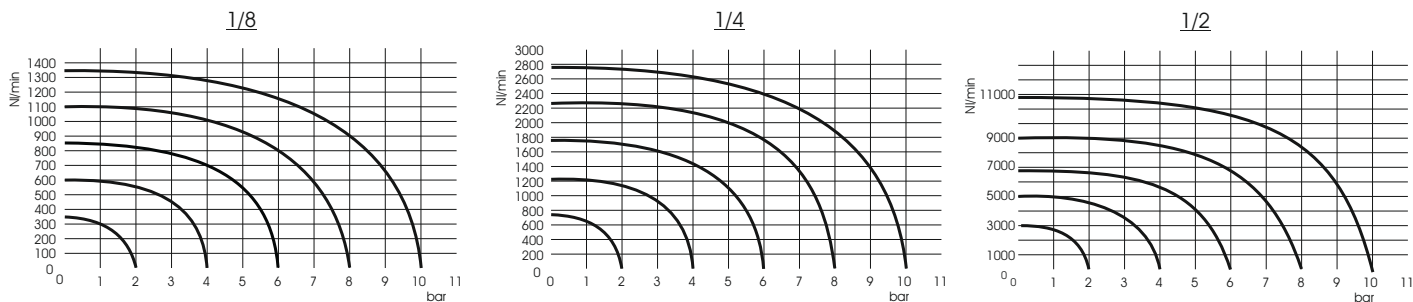

FAST SELECT / SELECTION RAPIDE / SELEZIONE RAPIDA

	monostable / monostable / monostabile VK83PNMNC 3/2 1/8 NC / NF / NC VK43PNMNC 3/2 1/4 NC / NF / NC VK23PNMNC 3/2 1/2 NC / NF / NC		bistable / bistable / bistabile VK85PNB00 5/2 1/8 VK45PNB00 5/2 1/4 VK25PNB00 5/2 1/2
	monostable / monostable / monostabile VK83PNMNA 3/2 1/8 NO / NO / NA VK43PNMNA 3/2 1/4 NO / NO / NA VK23PNMNA 3/2 1/2 NO / NO / NA		monostable / monostable / monostabile VK86PNMCC 5/3 1/8 CC / CF / CC VK46PNMCC 5/3 1/4 CC / CF / CC VK26PNMCC 5/3 1/2 CC / CF / CC
	bistable / bistable / bistabile VK83PNB00 3/2 1/8 VK43PNB00 3/2 1/4 VK23PNB00 3/2 1/2		monostable / monostable / monostabile VK86PNMCA 5/3 1/8 CO / CO / CA VK46PNMCA 5/3 1/4 CO / CO / CA VK26PNMCA 5/3 1/2 CO / CO / CA
	monostable / monostable / monostabile VK85PNM00 5/2 1/8 VK45PNM00 5/2 1/4 VK25PNM00 5/2 1/2		monostable / monostable / monostabile VK86PNMCP 5/3 1/8 CP / CP / CP VK46PNMCP 5/3 1/4 CP / CP / CP VK26PNMCP 5/3 1/2 CP / CP / CP

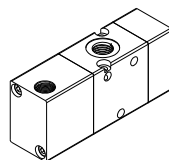
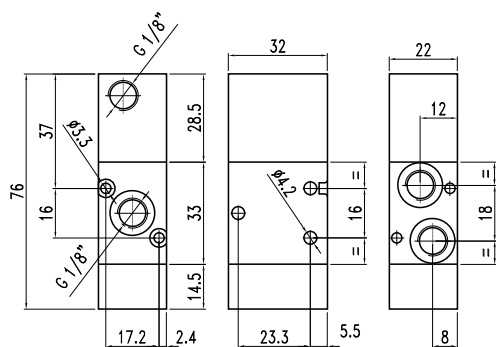

1/8 - 3/2 NC monostable  
1/8 - 3/2 NF monostable  
1/8 - 3/2 NC monostabile

CODE: VK83PNMNC

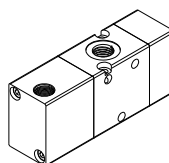
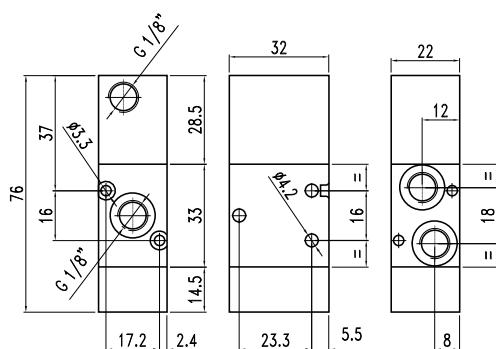
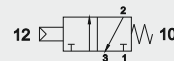

1/8 - 3/2 NO monostable  
1/8 - 3/2 NO monostable  
1/8 - 3/2 NA monostabile

CODE: VK83PNMNA

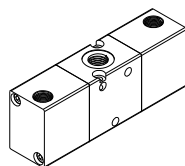
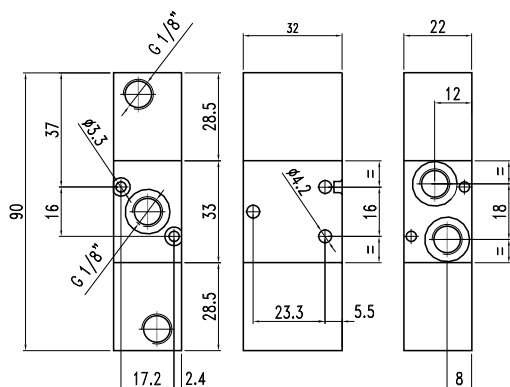
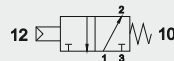

1/8 - 3/2 bistable  
1/8 - 3/2 bistable  
1/8 - 3/2 bistabile

CODE: VK83PNB00

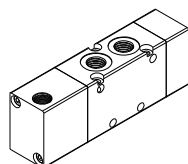
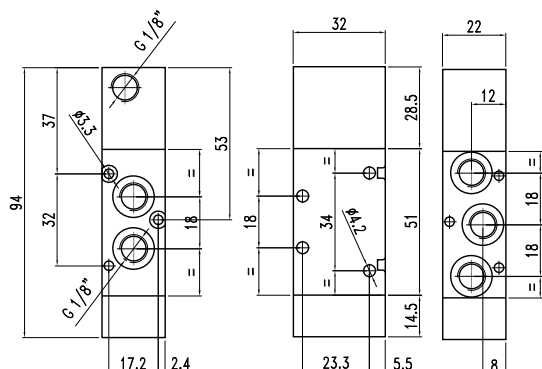
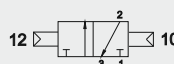

1/8 - 5/2 monostable  
1/8 - 5/2 monostable  
1/8 - 5/2 monostabile

CODE: VK85PNM00

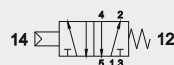



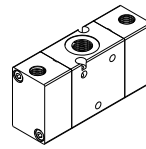
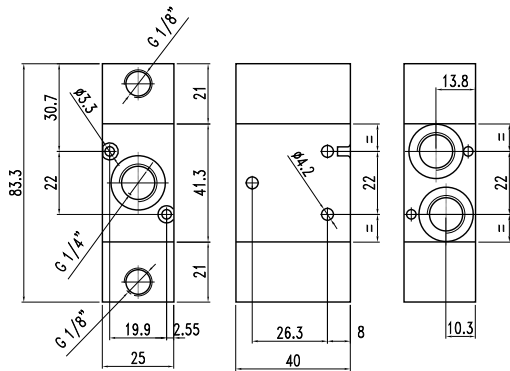

1/4 - 3/2 bistable  
1/4 - 3/2 bistable  
1/4 - 3/2 bistabile

CODE: VK43PNB00

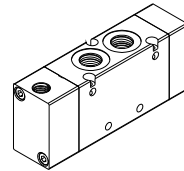
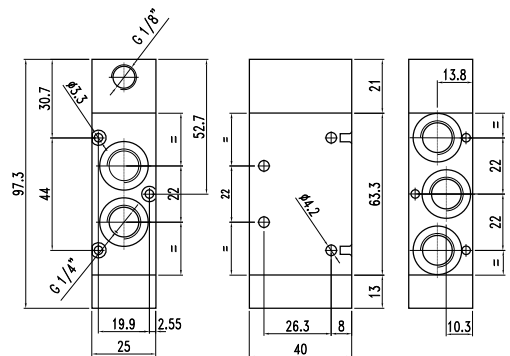
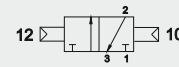

1/4 - 5/2 monostable  
1/4 - 5/2 monostable  
1/4 - 5/2 monostabile

CODE: VK45PNM00

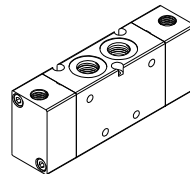
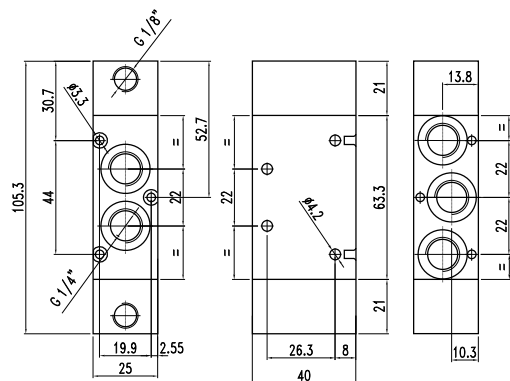
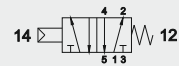

1/4 - 5/2 bistable  
1/4 - 5/2 bistable  
1/4 - 5/2 bistabile

CODE: VK45PNB00

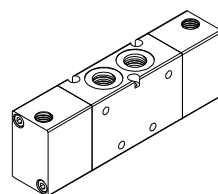
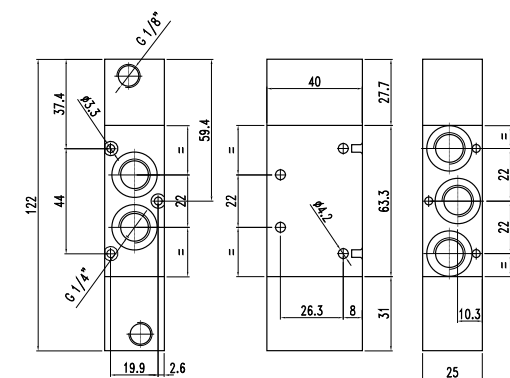

1/4 - 5/3 monostable  
1/4 - 5/3 monostable  
1/4 - 5/3 monostabile

CODE: VK46PNMCC



closed centres  
centre fermé  
centri chiusi

CODE: VK46PNMCA



open centres  
centre ouvert  
centri aperti

CODE: VK46PNMCP



press. centres  
centre en pression  
centri in pressione

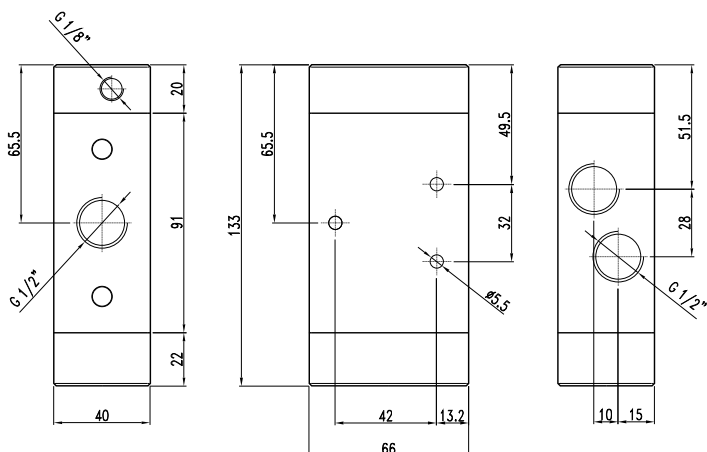

1/2 - 3/2 NC monostable  
1/2 - 3/2 NF monostable  
1/2 - 3/2 NC monostabile

CODE: VK23PNMNC

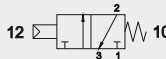

1/2 - 3/2 NO monostable  
1/2 - 3/2 NO monostable  
1/2 - 3/2 NA monostabile

CODE: VK23PNMNA

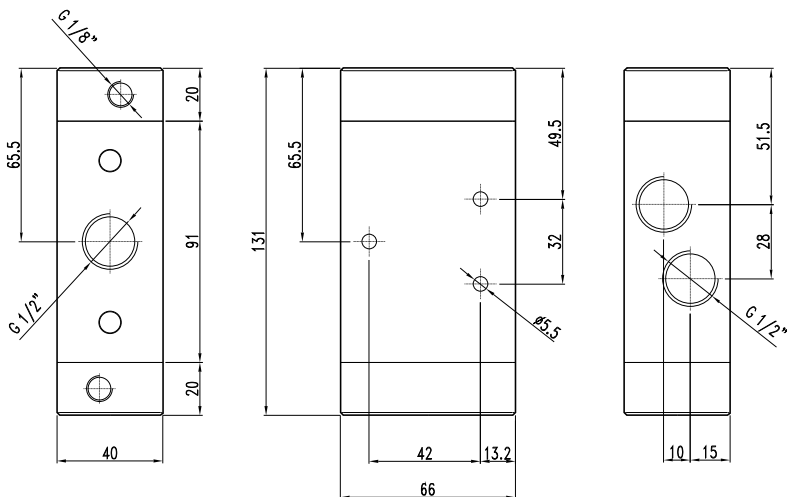
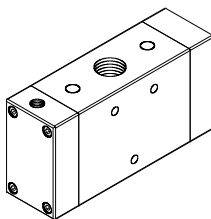
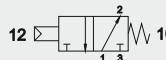

1/2 - 3/2 bistable  
1/2 - 3/2 bistable  
1/2 - 3/2 bistabile

CODE: VK23PNB00

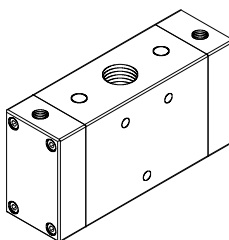
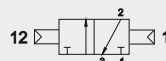

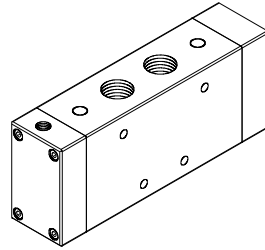
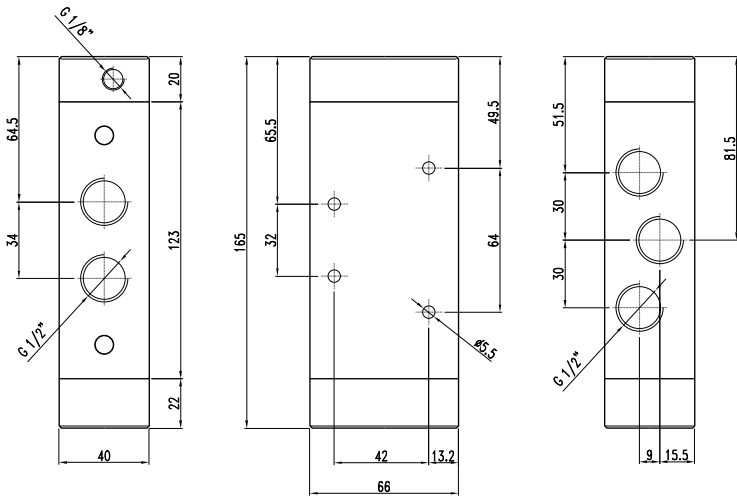

1/2 - 5/2 monostable  
1/2 - 5/2 monostable  
1/2 - 5/2 monostabile

CODE: VK25PNM00

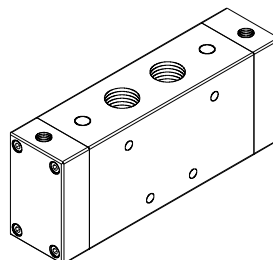
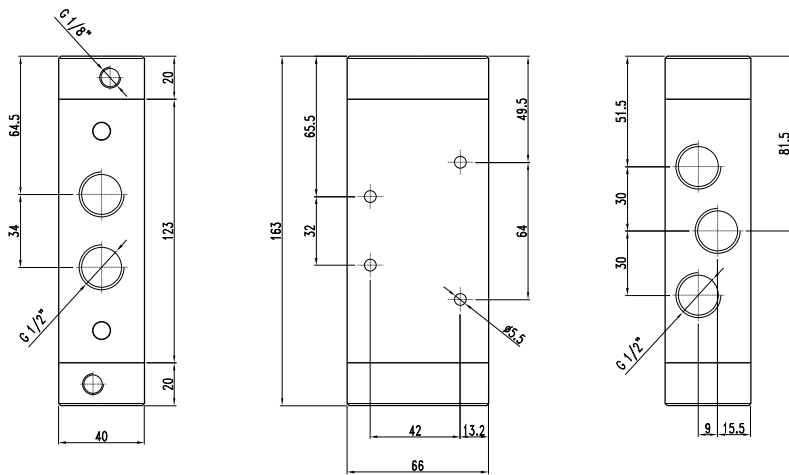
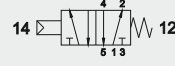

1/2 - 5/2 bistable  
1/2 - 5/2 bistable  
1/2 - 5/2 bistabile

CODE: VK25PNB00

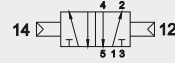

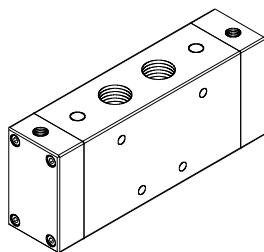
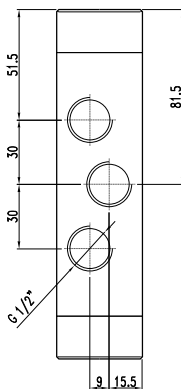
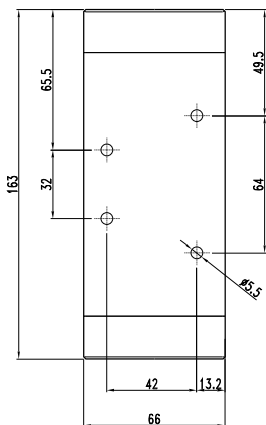
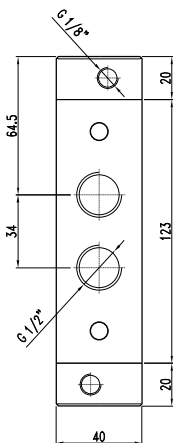

1/2 - 5/3 monostable  
1/2 - 5/3 monostable  
1/2 - 5/3 monostabile

CODE: VK26PNMCC

closed centres  
centre fermé  
centri chiusi



CODE: VK26PNMCA

open centres  
centre ouvert  
centri aperti



CODE: VK26PNMCP

press. centres  
centre en pression  
centri in pressione

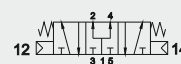

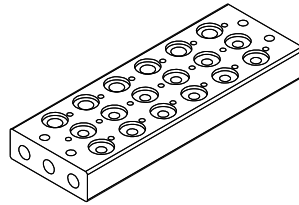
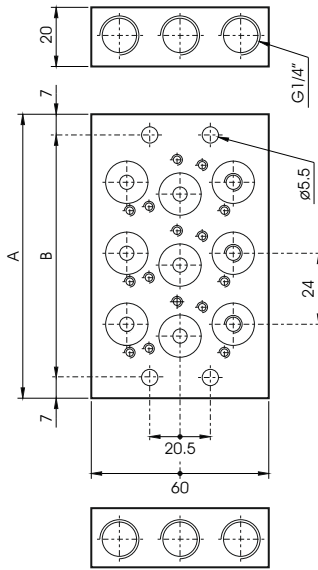

MANIFOLD FOR 1/8 VALVES  
EMBASE MULTIPLE POUR VALVE 1/8  
SOTTOBASE PER VALVOLE 1/8

CODE	STATIONS	A	B
SB407202	2	72	58
SB407203	3	96	82
SB407204	4	120	106
SB407205	5	144	130
SB407206	6	168	154
SB407207	7	192	178
SB407208	8	216	202
SB407209	9	240	226
SB407210	10	264	250

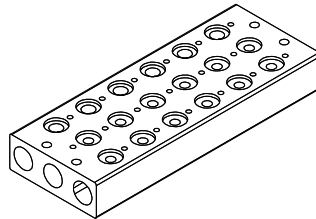
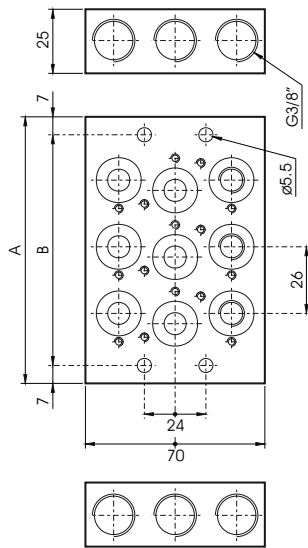

MANIFOLD FOR 1/4 VALVES  
EMBASE MULTIPLE POUR VALVE 1/4  
SOTTOBASE PER VALVOLE 1/4

CODE	STATIONS	A	B
SB407302	2	78	64
SB407303	3	104	90
SB407304	4	130	116
SB407305	5	156	142
SB407306	6	182	168
SB407307	7	208	194
SB407308	8	234	220
SB407309	9	260	246
SB407310	10	286	272

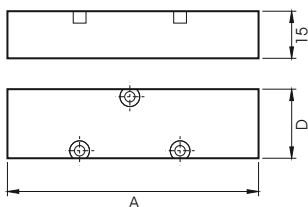

BLANKING PLATE  
PLAQUE DE FERMETURE  
PIASTRINA DI CHIUSURA

CODE		A	D
SB40720004	1/8	60	22
SB40730004	1/4	70	25